

# Installation instruction for: A Dual Flush Toilet Mechanism and Fill Valve with Drain

## A.Installation Instruction Fill Valve Mechanism

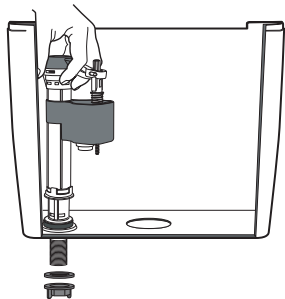

1.Insert the new fill valve with rubber seal at the base in the inlet hole of water tank and screw on the nut with collar tightly.

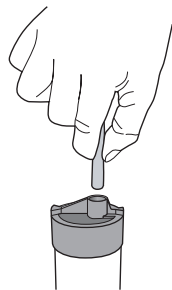

2.Connect the refill tube with refill restrictor from fill valve to the overflow pipe of the flush valve.

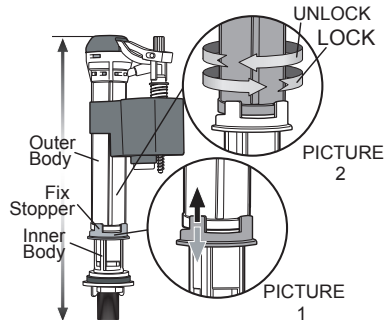

3.At the base of the fill valve's outer body, unlock the fix stopper(see picture 1)by pushing it down,then twist the outer body (see picture 2) clockwise to unlock.Adjust the outer body to the desired height. After setting it,twist the outer body counter clockwise to lock it to that position then pull the fix stopper upward to secure it.

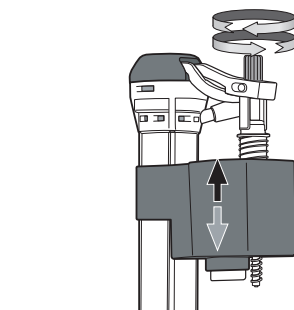

4.Fine and final adjustment can be made by rotating the screw rod clockwise or counter-clockwise on the fill valve cup.In order to achieve desired water level.

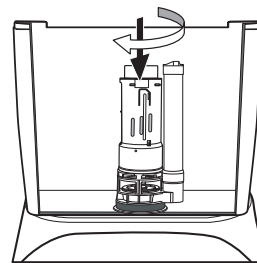

4.Take the body of flush valve and set it into the base and lock in place by rotating it clockwise.

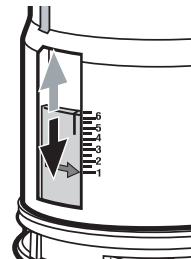

6.Adjust the full flush volume by sliding the red part up or down.when the buoy is higher.the discharge water volume is less.slide down the part can buoy little until you are flushing enough water.

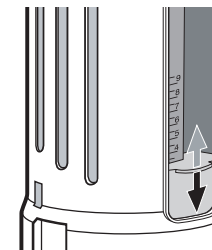

5.Adjust the half flush volume by sliding the marked part up or down.when the buoy is higher.the discharge water volume is less.slide down the part can buoy little until you are flushing enough water.

## Push Button installation for top ceramic hole

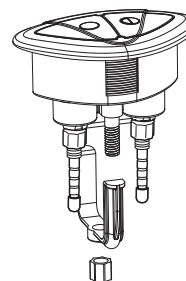

Unscrew Fix nut and U Buckle.

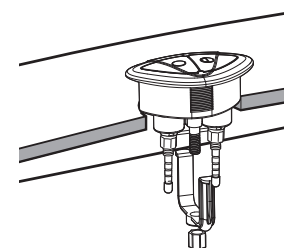

Insert Button Body in the button hole of lid and separately level the Full Flush Button and Partial Flush Button of Push Button at those of Flush Valve, then load U Buckle into Button Body (as picture) and screw Fix Nut to U Buckle tightly.

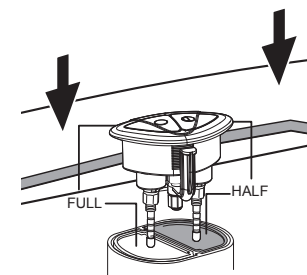

Loose Eight-square Nut and adjust the height of Rod to expected, then screw Eight-square Nut tightly.

## B.Installation Instruction Dual Flush Valve Mechanism

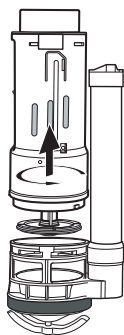

1. Hold the base of the flush valve and rotate the body counter-clockwise. Take it out from base.

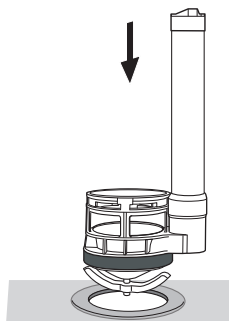

2.Put the base into the ceramic hole.

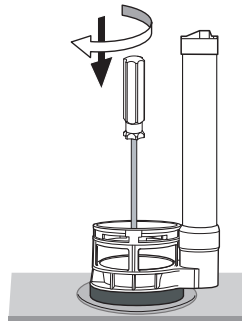

3. Use screwdriver to screw up the nut tightly.

## Installation instruction for: A Dual Flush Toilet Mechanism and Fill Valve with Drain

### A. Installation Instruction Fill Valve Mechanism

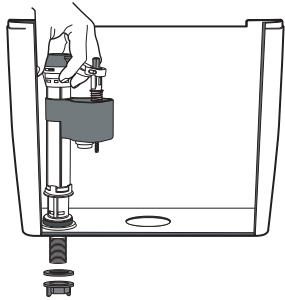

1. Insert the new fill valve with rubber seal at the base in the inlet hole of water tank and screw on the nut with collar tightly.

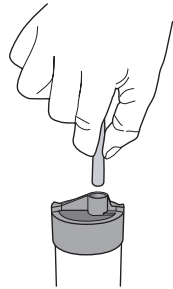

2. Connect the refill tube with refill restrictor from fill valve to the overflow pipe of the flush valve.

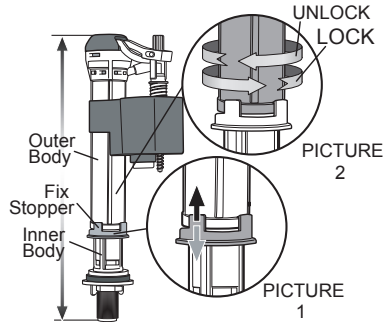

3. At the base of the fill valve's outer body, unlock the fix stopper (see picture 1) by pushing it down, then twist the outer body (see picture 2) clockwise to unlock. Adjust the outer body to the desired height. After setting it, twist the outer body counter clockwise to lock it to that position then pull the fix stopper upward to secure it.

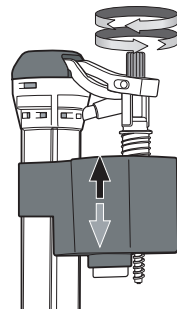

4. Fine and final adjustment can be made by rotating the screw rod clockwise or counter-clockwise on the fill valve cup. In order to achieve desired water level.

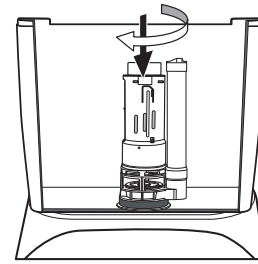

4. Take the body of flush valve and set it into the base and lock in place by rotating it clockwise.

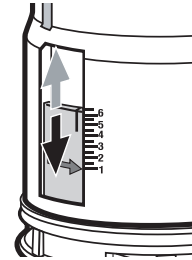

6. Adjust the full flush volume by sliding the red part up or down. When the buoy is higher, the discharge water volume is less. Slide down the part can buoy little until you are flushing enough water.

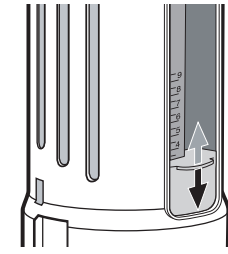

5. Adjust the half flush volume by sliding the marked part up or down. When the buoy is higher, the discharge water volume is less. Slide down the part can buoy little until you are flushing enough water.

### Push Button installation for top ceramic hole

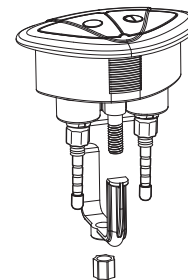

Unscrew Fix nut and U Buckle.

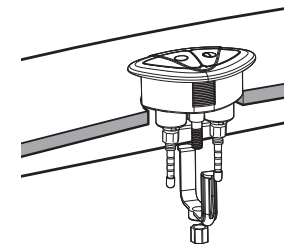

Insert Button Body in the button hole of lid and separately level the Full Flush Button and Partial Flush Button of Push Button at those of Flush Valve, then load U Buckle into Button Body (as picture) and screw Fix Nut to U Buckle tightly.

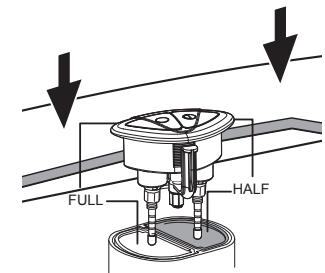

Loose Eight-square Nut and adjust the height of Rod to expected, then screw Eight-square Nut tightly.

### B. Installation Instruction Dual Flush Valve Mechanism



1. Hold the base of the flush valve and rotate the body counter-clockwise. Take it out from base.

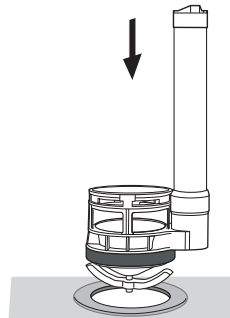

2. Put the base into the ceramic hole.

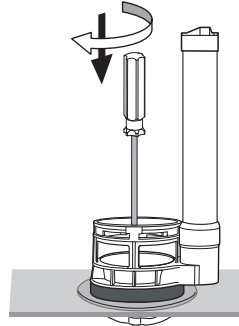

3. Use screwdriver to screw up the nut tightly.